

Dual display support and comprehensive I/O ports provide superior connectivity and expandability



24/7 Reliability



10th Gen Intel Processors



Thunderbolt™



DDR4 Memory



2.5" HDD or 2.5" SSD



Wi-Fi 5 802.11ac



Wi-Fi 6 802.11ax



2.5G LAN



PD Input



Kensington Lock



4K



4 Displays

Powerful performance for daily multitasking

- Featuring 10th Generation Intel® Core™ processors and ready to take on demanding workloads
- With DDR4 2666MHz memory, ASUS Mini PC PN62 provides excellent performance for daily computing tasks
- Three thermal policies are designed in the BIOS so that users can choose according to the situation

Enhance productivity, maximum possibilities

- Features an array microphone that supports Cortana, the personal digital assistant that helps you get things done easily
- stunning 4K UHD resolution and dual displays for more efficient and comfortable productivity experiences

High-speed connectivity and legacy support

- USB 3.2 Gen2 Type-C port with Battery Charging 1.2 and PD in support for more convenient
- Onboard 2.5GbE LAN delivering faster Ethernet connectivity
- Optional Thunderbolt™ 3 connectivity for ultrafast transfer speeds of up to 40Gpbs or a variety of other connectivity options

Versatile design

- One configurable port support (options: Thunderbolt 3/ Display Port 1.2/ COM/ VGA/ Intel® LAN)

Over view:

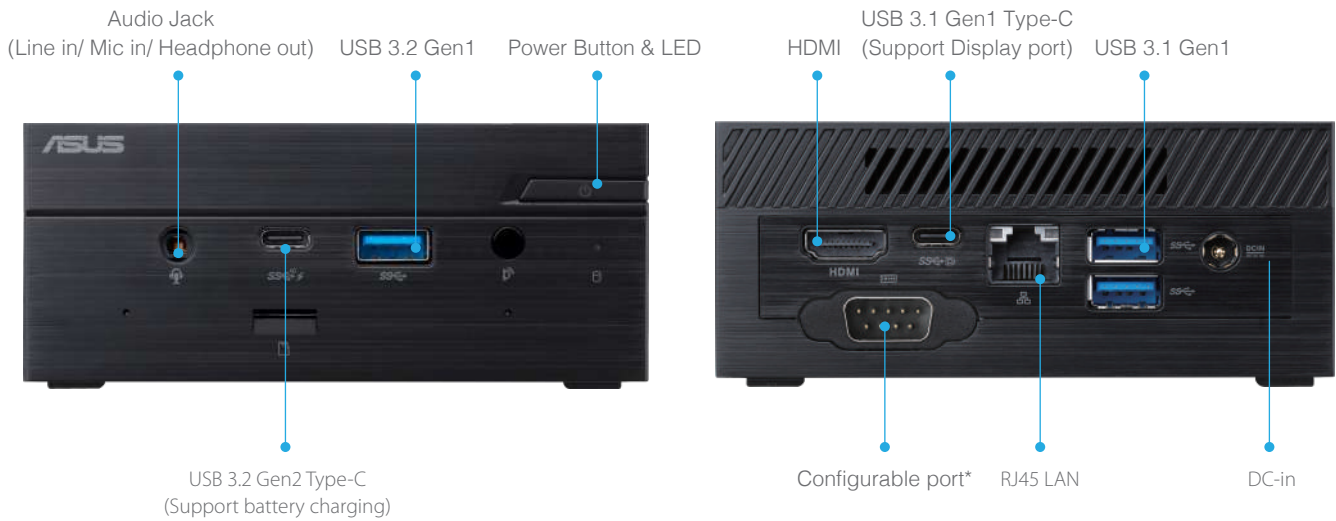

Accessories list:



- Power Cord
- AC Adapter (80cm)
- Quick Start Guide & Warranty Card
- VESA Mount Kit (Optional)
- Keyboard & Mouse (Optional)
Wired / Wireless

Feature table:

Power	
PD input	Y
Extended Power Button	N
BIOS	
AC Power loss	Y
HDMI-CEC	N
CrashFree	Y
EZ Flash	Y
BIOS Customization	Y
PXE/WOL	Y
USB Single Port Control	Y

Security	
fTPM 2.0	Y
dTPM 2.0	optional
Kensington lock	Y
Pad-lock	N
Chassis Intrusion	N
Reliability	
24/7 Durability Test	Y
Military-grade Durability	N
Anti-Surge	Y
Fanless	N

Remote	
ASUS Control Center	optional
Watchdog timer	optional
ASUS Cooperate Stable Model	optional
MyLogo	Y
MyASUS / CSM	
Smart Fan Control	N
AI Noise Cancelation	N
Wi-Fi Smart Connect	N

Model		PN62
OS		Windows®11 64bit, Windows®11 Pro 64bit, Linux, or W/O OS (Please check with local rep on validated Linux version)
CPU		Intel® Core™ i7-10710U/ i7-10510U/ i5-10210, i3-10110U (cTDP:15W)
Chipset		Integrated
Graphics		Integrated - Intel® UHD Graphics
Memory		2 x DDR4 SO-DIMM slots for DDR4 2666 MHz, 1 x 8GB - 2 x 32GB (total)
Storage		1 x 6Gb/s SATA connector for 2.5" 1TB HDD/SSD* 1 x M.2 2280 PCIe/SATA slot for 128GB - 256GB SSD* (NVMe only) <small>*For higher capacity please refer to QVL (location: official website → Support → CPU / Memory Support)</small>
Wireless Network		Intel® Wi-Fi 6 and Bluetooth 5 Intel® Wi-Fi 5 and Bluetooth 4
LAN		Intel® LAN, 10/100/1000 Mbps Supports Wake on LAN / PXE / Auto Power on / RTC Wake
Interface	Front I/O	1 x USB 3.2 Gen2 Type-C (10 Gbps, support Charging 1.2) 1 x USB 3.2 Gen1 (5 Gbps) 1 x Audio Jack (Line out/ Mic in/ Headphone out) 2 x Microphone Array 1 x IR receiver 1 x 3 in 1 Card Reader (Micro SD/Micro SDHC/Micro SDXC) <small>*All data transfer speed is according to ASUS testing result, actual performance may vary depending on objective environmental changes.</small>
	Side I/O	1 x Kensington Lock
	Rear I/O	1 x USB 3.2 Gen1 Type-C (5 Gbps, Support Charging 1.2, PD power input*) 2 x USB 3.2 Gen1 (5 Gbps) 1 x HDMI 2.0 Port 1 x Configurable Port (options: Thunderbolt 3/ Display Port 1.2/ COM/ VGA/ Intel® LAN) 1 x Intel LAN (RJ45) 1 x DC-in <small>*Power supply device need to support Power Delivery & at least 65W output. **Supports up to two display via USB 3.2 Gen1 Type-C and configurable ports, or USB 3.2 Gen 1 Type-C and HDMI.</small>
TPM		fTPM 2.0 or TPM 2.0 chip (Optional)
BIOS Function		64 Mb Flash ROM, UEFI AMI BIOS, PnP, DMI2.0, WfM2.0, SM BIOS 2.8, ACPI 5.0, Multi-language BIOS, ASUS EZ Flash 3, ASUS CrashFree BIOS 3, My Favorites, Quick Note and ASUS DRAM SPD (Serial Presence Detect) memory information
Software		The following software are included in OS: ASUS Business manager, ASUS Product registration program, Asus Control Center test, Watchdog timer
Power Supply		19Vdc, 3.42A, 65W 19Vdc, 4.74A, 90W (Thunderbolt SKU)
Physical	Dimension	115 x 115 x 49 mm (0.62L)
	Weight	0.55 kg (barebone)
Max Resolution	HDMI	4096 x 2160 @ 60 Hz
	DP	4096 x 2304 @ 60 Hz
	VGA	1920 x 1200 @ 60 Hz
Temperature	Operating	0°C~50°C
	Storage	-40°C~85°C
Humidity		0%~95% Relative Humidity
Acoustic	Idle mode	<25 dBA
	Full loading	<37 dBA <small>* Test results will vary slightly depending on the HDD/SSD SKU selected by customer</small>
Certificates		BSMI / CB / CE / FCC / UL / CCC / Energy Star / C-Tick / WiFi / RF / VCCI